



# CONCRETE ACCESSORIES

## Sika® Greenstreak®

# CONCRETE FORM LINERS

GIVING FORM TO CREATIVE ARCHITECTURAL IDEAS

**BUILDING TRUST**  
**CONSTRUIRE LA CONFIANCE**



# ARCHITECTURAL CONCRETE FORM LINERS

**BECAUSE OF ITS STRENGTH AND VERSATILITY, CONCRETE CONTINUES TO GAIN POPULARITY AS THE BUILDING MATERIAL OF CHOICE. MORE AND MORE, OWNERS, DESIGNERS AND CONTRACTORS REFUSE TO SETTLE FOR PLAIN, UNADORNED CONCRETE.**

For generations, Sika has been proud to promote and advance the use of concrete, and architectural concrete is no exception. Since 1975, Sika has been at the forefront of technology for texturing tilt-up, cast-in-place and precast concrete.

Sika® Greenstreak® Form Liners provide an economical means for adding interest and visual appeal to almost any concrete structure. The desire for architectural concrete continues to grow in both the public and private sectors and the applications for Sika® Greenstreak® Form Liners are limitless.

## A SAMPLING OF APPLICATIONS

- Commercial and industrial complexes and buildings
- Institutions
- Community centres
- Sports and entertainment complexes
- Amusement and theme parks
- Water and waste water treatment facilities
- Transportation ports and terminals
- Bridge abutments and columns
- Sound barrier walls
- Retaining walls
- Corporate signs and planters
- Residential buildings

Sika® Greenstreak® Form Liners attach to almost any forming system or casting bed prior to concrete placement. Following normal placement practices and curing times, the forming system and liner are stripped, leaving an architectural concrete finish.

Sika offers a wide array of patterns and textures from which to choose. Patterns are available in a variety of sizes and depths to achieve the best visual effect.

## TYPICAL PATTERNS

- Trapezoidal rib
- Fractured rib and fin
- Natural and cut stone
- Brick and block
- Wood and plank
- Sandblast and exposed aggregate finishes

## CUSTOM PATTERNS AND GRAPHICS

If standard patterns do not meet a specific need, Sika Greenstreak can consider submissions for a custom pattern, texture or graphic. Please contact our Technical Services Department for consultation on custom patterns.



Precast (no. 439)



Cast-in-place



Tilt-up

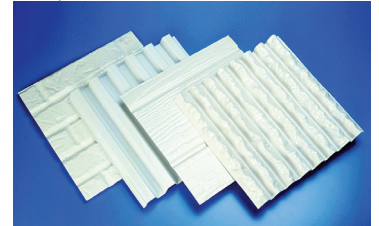

## CASTING COST EFFECTIVELY

Sika® Greenstreak® Form Liners are available in three grades to economically cast an architectural finish in concrete structures of all sizes, types and budgets.

For some projects, it may be more cost effective to use more than one grade. When using multiple grades, it may be necessary to shim the Form Liner to compensate for thickness variations from grade to grade.

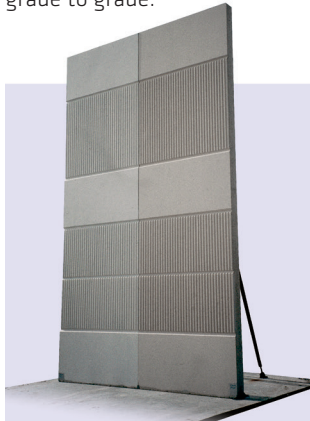

GRADE	MATERIAL TYPE	DESCRIPTION
UNI-CAST®	Rigid Polymer (HIPS)	A single-use Form Liner ideal for tilt-up panels and cast-in-place construction requiring cut-outs for doors, windows, utilities, etc.
MULTI-CAST®	Rigid Polymer (ABS)	Intermediate-use Form Liner designed for 2 to 10 uses under normal job site conditions. Primarily used for cast-in-place applications.
DURA-CAST®	Rigid Polymer (ABS)	Intermediate-use Form Liner designed for 10 to 25 uses under normal job site conditions. Used for cast-in-place and gang forming applications.

Typical sheet size is 4' x 10' but varies with pattern. Not all patterns are available in all grades. Each pattern detail shown in this catalogue provides information on availability.

## IMPORTANT FACTORS TO REMEMBER

- Pre-construction mock-up is required and must reflect actual job site conditions for warranty to remain in effect.
- Some deeper patterns require back-up strips and are noted on the pattern details shown in this catalog. Please refer to the section of this catalogue regarding back-up strips for additional information.
- Listed Form Liner dimensions are nominal. Changes in temperature can cause the liner to expand or contract. Allow for dimensional variations in the design and installation.
- All Form Liners are UV stabilized; however, protect liners from over exposure to direct sunlight.
- Rigid Polymer liners will become more rigid at temperatures below 0°C. Use extra care under these conditions.
- Concrete temperatures in excess of 60°C will adversely affect the material properties of the Form Liners. Sika does not recommend the use of Form Liners in these applications.
- Rigid Polymer liners are NOT recommended for precast applications using heated beds.
- Type 3 concrete with accelerators create high heat during cure which could damage Rigid Polymer Form Liners.
- Rustication strips are recommended at the liner joints that do not blend with the pattern.
- Use Sika Greenstreak No. 7000 Form Release.
- Although UNI-CAST Form Liners do not require a release agent, Sika® Greenstreak®'s Form Release 7000 is highly recommended to enhance the appearance of the concrete.
- Use one concrete supplier for uniformity of colour and texture.
- Place concrete with an elephant trunk to minimize aggregate segregation.
- Vibrate concrete to eliminate lift lines and minimize air voids.
- Clean the liner between castings with a mild detergent and scrub brush.
- Consult Sika Canada for further specification information.
- See ACI 303R-04 "Guide to Cast-In-Place Architectural Concrete Practice" for further recommendations in design and use.



# FORM LINER PATTERNS AND TEXTURES

Sika® Greenstreak® Form Liners are available in a variety of patterns and textures and most are offered in at least three different grades. Please consult Sika Canada to determine the most suitable liner for your application and forming technique.

**Not all Sika® Greenstreak® patterns are shown in this catalogue. Call Sika Canada for additional pattern details, or if you would like us to create a custom pattern or design.**

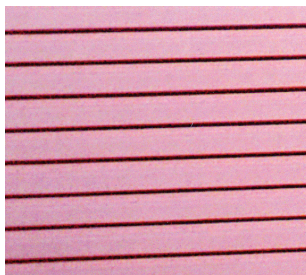

No. 334



No. 302



Trapezoidal and Fractured Rib Designs can be used horizontally in Tilt-up and Precast applications.

**Ribbed patterns should only be used vertically in Cast-in-place applications.**



No. 304

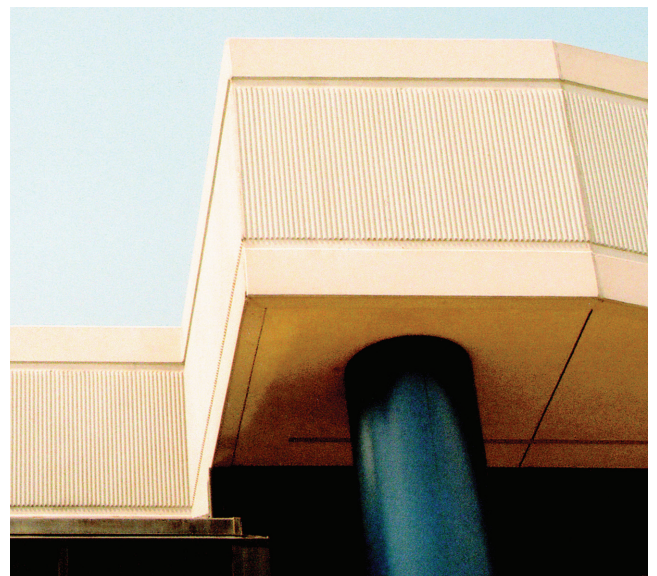

*(Not all patterns are shown in this catalog.)  
All dimensions nominal*



## RIBBED DESIGNS

**No. 301** U,M  
3'-11 1/2" x 9'-11" Sheets • Trapezoid

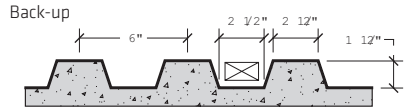

**No. 305** U,M  
4'-1" x 10' Sheets • Trapezoid

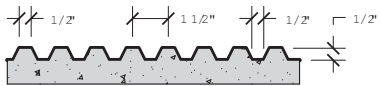

**No. 310** U,M  
10' x 4' Sheets • Trapezoid

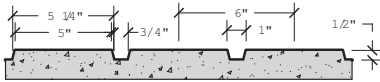

**No. 334** U,M  
3'-10--3/4" x 10' Sheets • Trapezoid

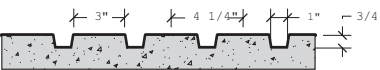

**No. 353** U,M,D  
3'-11 3/4" x 9'-10" Sheets • Random Parallel Reveals

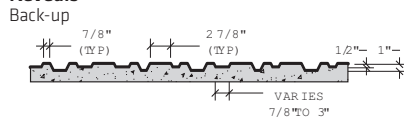

**No. 362** U,M  
4' x 9'-10" Sheets • Random Reveal AZ D.O.T.

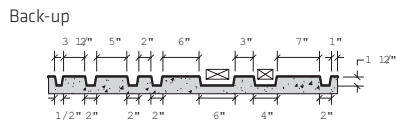

**No. 302** U,M,D  
3'-11 3/4" x 10' Sheets • Trapezoid

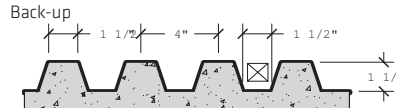

**No. 308** U,M  
4' x 10' Sheets • Trapezoid

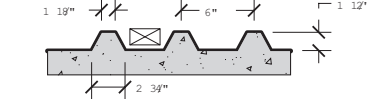

**No. 312** U,M  
3'-11 1/2" x 10' Sheets • Trapezoid

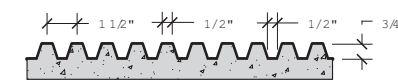

**No. 335** U,M  
4' x 10' Sheets • Random Rib

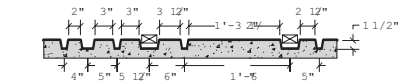

**No. 359** U,M  
4' x 9'-6" Sheets • Trapezoid

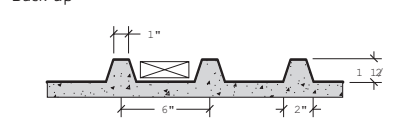

**No. 396** U,M  
4'-0 1/8" x 10' Sheets • Trapezoid

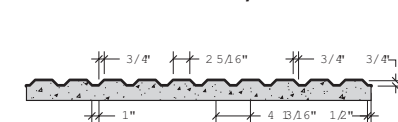

**No. 304** U,M,D  
4' x 10' Sheets • Trapezoid

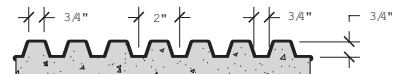

**No. 309** U,M  
4' x 10' Sheets • Random Reveal

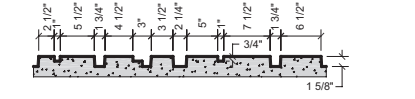

**No. 333** U,M  
4' x 10' Sheets • Trapezoid

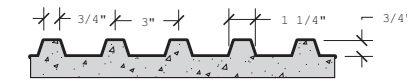

**No. 339** U,M  
4' x 10' Sheets • Trapezoid

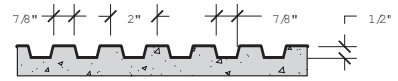

**No. 361** U,M  
4' x 9'-10" Sheets • Random Reveal

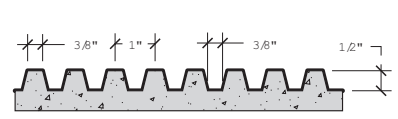

This symbol indicates patterns recommending back-up strips. Please refer to the section of this catalogue regarding back-up strips for additional information.

Not all patterns are available in all grades. Grades available for each pattern detail are designated as follows:

U = Uni-Cast® M = Multi-Cast® D = Dura-Cast®

## STONE DESIGNS

**No. 328** U,M  
9'-10 3/4" x 3'-11 1/2" Sheets •  
**Drystack Random Stone**  
Relief: Varies 1/2" - 1 1/2"



**No. 439** M  
7'-10 3/8" x 3'-10 3/4" Sheets • **Sierra Drystack**  
Relief: 1 1/2" maximum



**No. 460** U,M  
10'-1" x 4'-0 1/2" Sheets • **Ashlar Cut Stone**  
Relief: 1 1/2" maximum

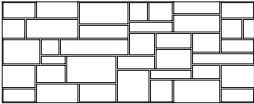

**No. 472** U,M  
10'-0 3/4" x 4'-0 1/4" Sheets • **Random Cut Stone**  
Relief: 1 5/8" maximum



**No. 329** U,M  
10' x 4' Sheets • **12" x 24" Running Bond Ashlar**  
Relief: 1 1/2" maximum

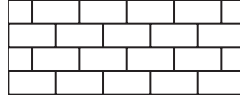

**No. 440** U,M  
10'-1" x 4'-0 1/4" Sheets • **River Rock**  
Relief: 2" maximum

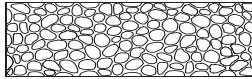

**No. 462** U,M  
10'-1" x 4'-0 1/2" Sheets • **Zion Stone**  
Relief: 2" maximum

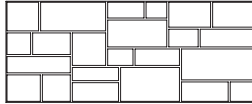

**No. 476** U,M  
9' x 3'-0 3/8" Sheets • **Running Bond Cut Stone**  
Relief: 1 1/4" maximum

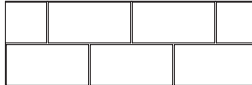

**No. 330** U,M,D  
10' x 4' Sheets • **Ashlar Stone**  
Relief: Varies 1/2" - 1 1/4"



**No. 454** U,M  
8' x 4' Sheets • **Spring Creek Stone**  
Relief: 3/4" maximum 1/2" - 3/4" average



**No. 468** U,M  
10'-0 1/2" x 3'-3 1/4" Sheets • **Willow Wall Stone**  
Relief: 2" maximum

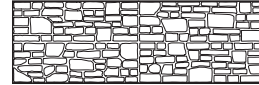

**No. 477** U,M  
10' x 4' Sheets • **Meramec Drystack Stone**  
Relief: 1 1/8" maximum



No. 328

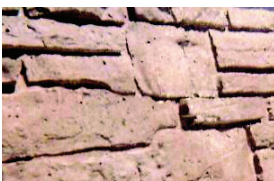

No. 439



No. 330





## BLOCK AND BRICK DESIGNS

**No. 303** U,M  
9'-5 1/2" x 3'-11 3/4" Sheets • **Smooth Face Block**

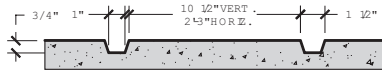

**No. 338** U,M,D  
9'-2" x 4' Sheets • **Rough Brick**

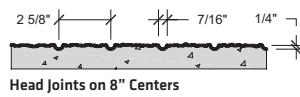

**No. 341** U,M  
4' x 10'-0 3/8" Sheets • **Square Split Face Block**

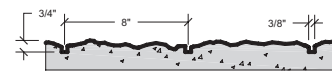

**No. 342** U,M  
9'-4" x 4' Sheets • **8" x 16" Split Face Block**

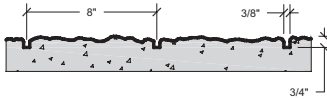

**No. 345** U,M  
10' x 4' Sheets • **12" Square Split Face Block**

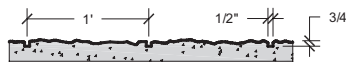

**No. 365** U,M  
9'-4" x 4' Sheets • **8" x 16" Cinder Block**

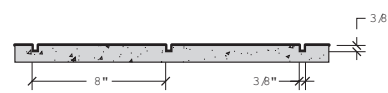

**No. 403** U,M  
10' x 4' Sheets • **Smooth Face Brick**

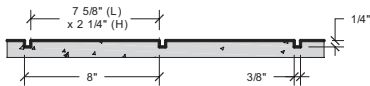

**No. 453** U,M  
10' x 4' Sheets • **Smooth Face Utility Brick**

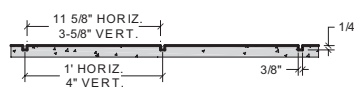

No. 342



No. 453

No. 329



No. 338



## FRACTURED DESIGNS

### No. 347 U,M

3'-11 1/2" x 9'-10" Sheets • Trapezoid with Aggregate Face

Back-up

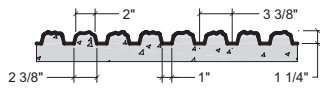

### No. 366 U,M,D

3'-11 1/4" x 10' Sheets • Fractured Rib

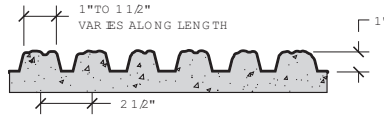

### No. 367 U,M,D

4' x 10' Sheets • Fractured Rib VA D.O.T.

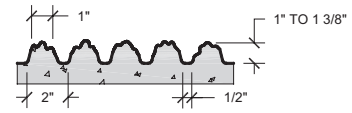

### No. 368 U,M,D

4'-1" x 10' Sheets • Trapezoid with Aggregate Face

Back-up

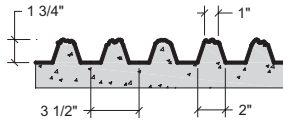

### No. 369 U,M,D

4' x 10' Sheets • Trapezoid with Aggregate Face

Back-up

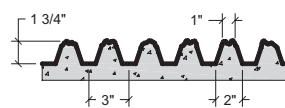

### No. 373 U,M,D

4' x 10' Sheets • Fractured Fin

Available with ribs rotated 45°

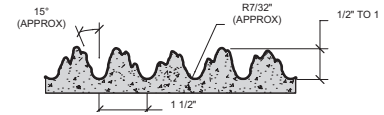

### No. 374 U,M

4' x 10' Sheets • Ripped Rope

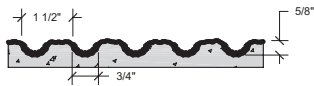

### No. 376 U,M

4' x 10' Sheets • Fractured Granite

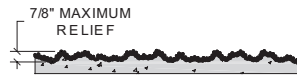

### No. 475 U,M

4' x 10' Sheets • Large Fractured Trapezoid

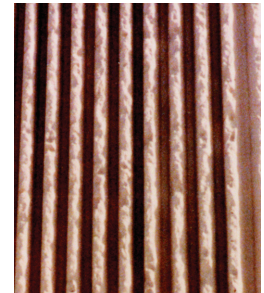
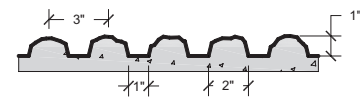

No. 367



No. 373





## WOOD DESIGNS

**No. 344** U,M,D  
4' x 9'-10" Sheets • Weathered Random Boards

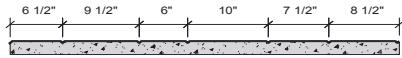

**No. 351** U,M  
3'-11 3/4" X 8'-11" Sheets • Rough Southern Yellow Pine

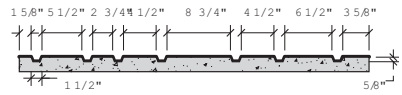

**No. 346** U,M,D  
4' x 9'-10" Sheets • Weathered Boards

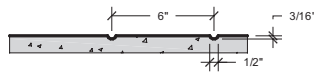

**No. 363** U,M,D  
3'-11 3/4" x 9'-10" Sheets • Weathered Tongue & Groove

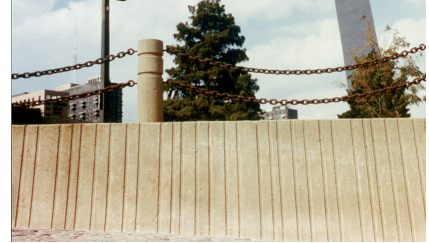
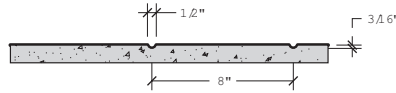

No. 351

## MISCELLANEOUS

**No. 340** U,M,D  
4' x 10' Sheets • Smooth Face

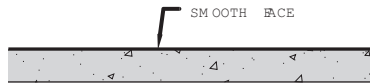

**No. 349** U,M,D  
4' x 10' Sheets • Light Sandblast Finish



**No. 350** U,M  
4' x 10' Sheets • Split Face Texture

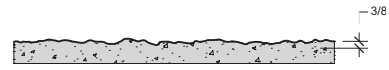

**No. 354** U,M  
4' x 10' Sheets • Striated Wave

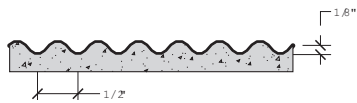

**No. 355** U,M  
4' x 10' Sheets • Random Striated Wave



**No. 357** U,M  
10' x 4' Sheets • Shiplap  
Back-up strips recommended

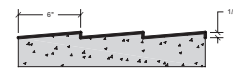

**No. 348** U,M,D  
4' x 10' Sheets • Medium Sandblast

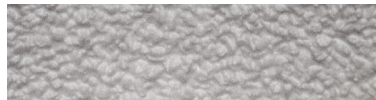
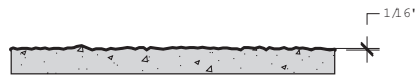

**No. 360** U,M,D  
4' x 10' Sheets • Riverbed Aggregate

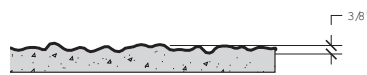

**No. 377** U,M,D  
4' x 10' Sheets • Flamed Granite

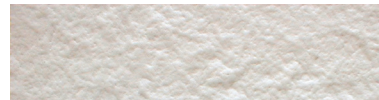
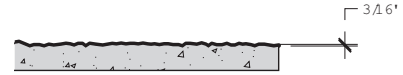

**No. 427** U,M,D  
4' x 10' Sheets • Flagstone

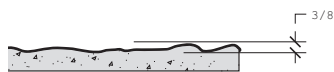

# FORMING AIDS AND ACCESSORIES

## FORM RELEASE 7000

Form Release 7000 is specially formulated to prevent concrete from bonding to aluminum, steel, plywood and plastic forms and Form Liners. Form Release 7000 should be used with all reusable Sika Greenstreak Form Liners.

### Advantages

- Will not stain or discolour concrete
- Leaves concrete ready for curing, sealing or painting
- Minimizes form clean-up
- Waterproofs plywood and helps prevent deterioration and corrosion of steel

### Coverage

- High coverage rate
- Steel, aluminum, plastic, high density plywood... 2000-2500 ft<sup>2</sup>/US gal.
- Medium density plywood... 1000-1500 ft<sup>2</sup>/US gal.
- Rough sawn lumber, striated plywood... 800-1000 ft<sup>2</sup>/US gal.

### Technical

- Contains no diesel fuel or kerosene
- Red label not required

## BACK-UP STRIPS

Foam or wood back-up strips provide additional support to prevent deflection of the Form Liner due to form pressures. Back-up strip recommendations are designated in pattern details.

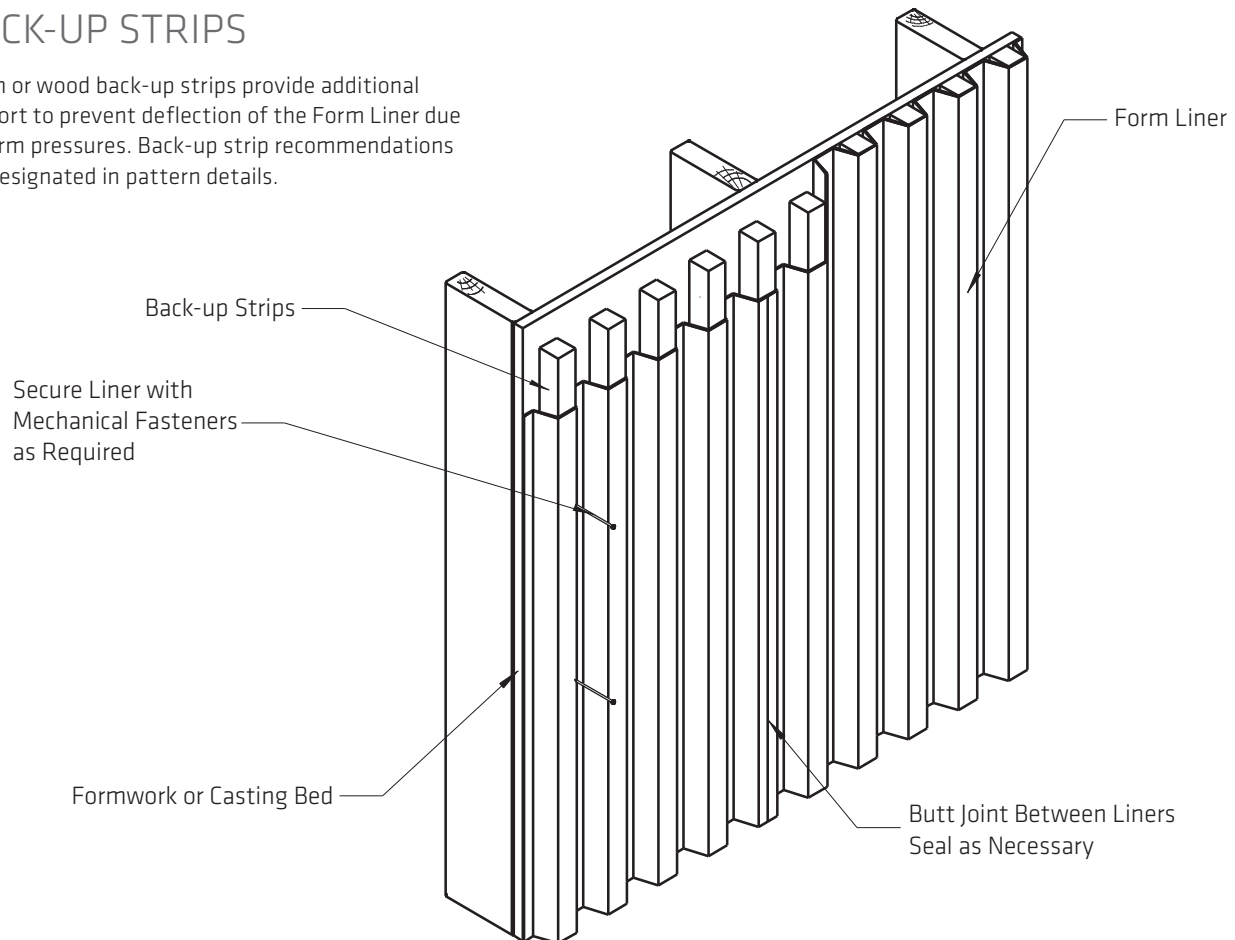

Cut Away View of Back-up Strips



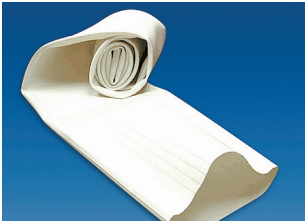

## ELEPHANT TRUNK & ACCESSORIES

Sika offers Elephant Trunk, Hoppers and Collars for proper placement of concrete. Placing architectural concrete with Elephant Trunk will minimize aggregate segregation.

### Technical Services

Sika Canada distributors have the knowledge and ability to answer most questions. If additional information is needed, product brochures, specification sheets and technical notes are available upon request.

Sika Canada Technical Sales Representatives are available for consultation during design, specification and product installation.

The following ACI Committee Reports are also recommended:

- ACI 117 “Specifications for Tolerances for Concrete Construction and Materials and Commentary”
- ACI 301; Ch. 6 “Specifications for Structural Concrete”
- ACI 303R “Guide to Cast-In-Place Architectural Concrete Practice”
- ACI 309; Ch. 7 “Guide for Consolidation of Concrete”
- ACI 347; Ch. 5 “Guide to Formwork for Concrete”

### Suggested Proprietary Short Form Guide Specification

Textured architectural concrete surfaces as indicated in drawings and specifications to be formed using Sika® Greenstreak® Architectural Form Liner Pattern Number \_\_\_\_\_,

as manufactured by

Sika Canada Inc., 601 Delmar Avenue,  
Pointe-Claire, Quebec H9R 4A9  
Phone 800-933-7452 or 514-697-2610.

Form Liner mock-up, storage, handling, accessories, fabrication, preparation and installation to comply with Sika Canada’s written instructions and recommendations. Sika Canada shall provide a Job Site Guide with the above listed Form Liner. A long form, 3 part master specification in CSI format is available upon request. Although proprietary, the master specification includes reference and performance standards.

# SIKA SOLUTIONS FROM ROOF TO FOUNDATIONS

## Roofing Systems



Sarnafil®  
Sikaplan®  
Sikalastic®

## Concrete Production



Sika® ViscoCrete®  
SikaRapid®  
Sika® Air

## Joint Sealing

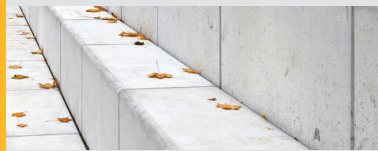

Sikaflex®  
Sikasil®  
Sikadur® Combiflex

## Grouting and Anchoring

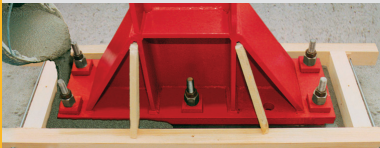

SikaGrout®  
Sikadur®  
Sika AnchorFix®

## Concrete Repair & Protection



Sika® MonoTop®  
SikaTop®, SikaRepair®  
Sikagard®

## Structural Strengthening



Sikadur®, Sika® CarboDur®  
SikaWrap®  
Sika® CarboShear

## Floor & Wall Systems



Sikafloor®  
Sikagard®  
Sikagard® Duroplast

## Waterproofing Systems



SikaProof®, SikaFuko®  
Sika® Greenstreak®  
SikaSwell®, SikaFix®

Sika Canada Inc., a member of the Sika Group, is a leader in the field of speciality chemicals for construction and manufacturing industries. Our product lines feature high quality roofing systems, concrete admixtures, mortars and resins, sealants and adhesives, structural strengthening components, industrial and decorative flooring, as well as protective coatings and waterproofing systems. Our expertise is borne out of a global presence and served by strong, local support. Sika has earned the trust of our customers for over 100 years, by delivering the highest standards of commitment and partnership.

## Also Available:

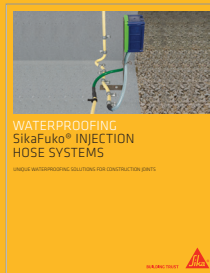

The information, and in particular, the recommendations relating to the application and end-use of Sika products, are given in good faith based on Sika's current knowledge and experience of the products when properly stored, handled and applied under normal conditions, within their shelf life. In practice, the differences in materials, substrates and actual site conditions are such that no warranty in respect of merchantability or of fitness for a particular purpose, nor any liability arising out of any legal relationship whatsoever, can be inferred either from this information, or from any recommendations, or from any other advice offered. The proprietary rights of third parties must be observed. All orders are accepted subject to our current terms of sale and delivery. Users should always refer to the most recent issue of the Product Data Sheet for the product concerned, copies of which will be supplied on request or can be accessed in the internet under [www.sika.ca](http://www.sika.ca).

### SIKA CANADA INC.

#### Head Office

601, avenue Delmar  
Pointe-Claire, Quebec  
H9R 4A9

#### Other locations

Toronto  
Edmonton  
Vancouver

1-800-933-SIKA  
[www.sika.ca](http://www.sika.ca)

An ISO 9001 certified company  
Pointe-Claire: ISO 14001 certified EMS

**BUILDING TRUST  
CONSTRUIRE LA CONFIANCE**

