

Sika® Greenstreak Waterstops

Concrete

Sikagard® M 790

Sikagard® P 770

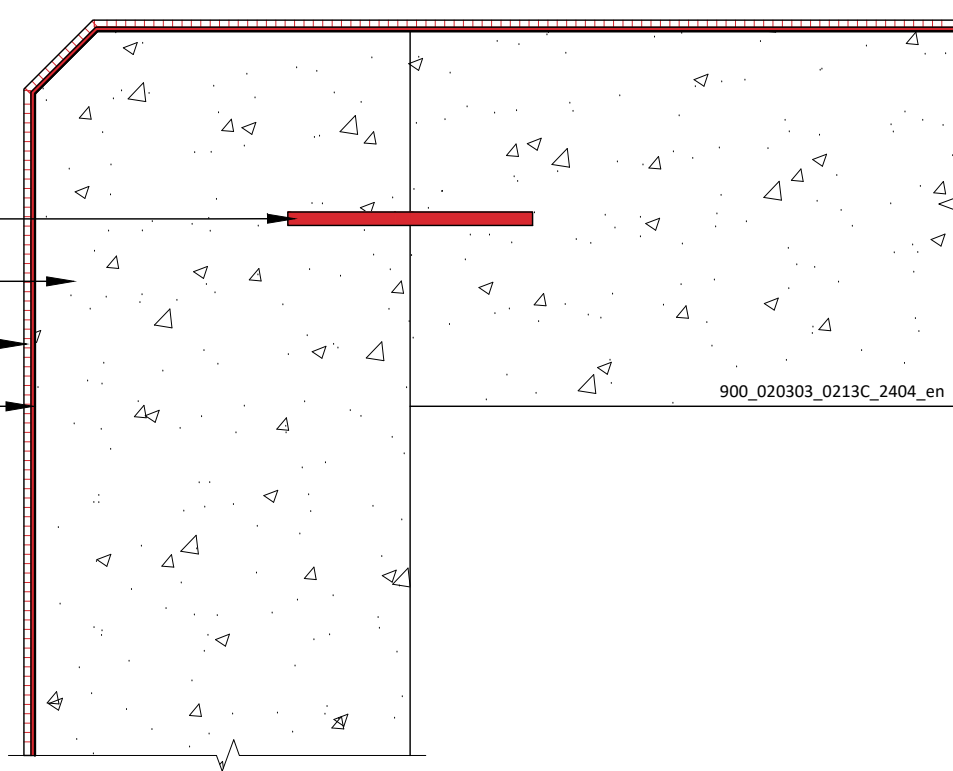

Sikagard®-7000 CR – DETAILING OF ANGLE

External edge

Sika General Detail

900_020303_0213C_2404_en
April 2024

Sika Canada Inc

601 Delmar av.

Pointe Claire

QC, H9R 4A9

Canada

<https://can.sika.com/>

BUILDING TRUST



DRAWING MUST ALWAYS BE REVIEWED BY A DESIGN SPECIALIST AND IF NECESSARY MODIFIED TO ENSURE SUITABILITY FOR THE SPECIFIC APPLICATION

The information contained herein and any other advice are given in good faith based on Sika's current knowledge and experience of the products when properly stored, handled and applied under normal conditions in accordance with Sika's recommendations. The information only applies to the application(s) and product(s) expressly referred to herein and is based on laboratory tests which do not replace practical tests. In case of changes in the parameters of the application, such as changes in substrates etc., or in case of a different application, consult Sika's Technical Service prior to using Sika products. The information contained herein does not relieve the user of the products from testing them for the intended application and purpose. All orders are accepted subject to our current terms of sale and delivery. Users must always refer to the most recent issue of the local Product Data Sheet for the product concerned, copies of which will be supplied on request.