

Sikafloor® PurCem®

Typical Installation Details

Sikafloor® PurCem® – Metallic stop end

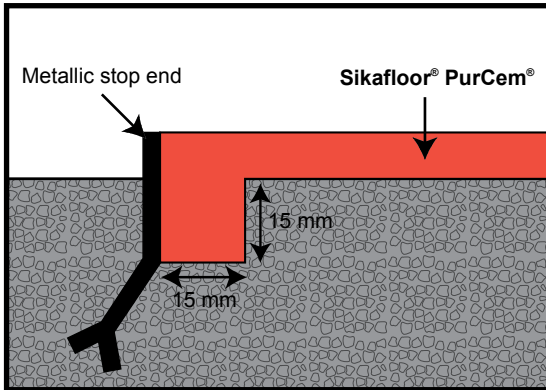

Sikafloor® PurCem® – “Keyed” edge detail

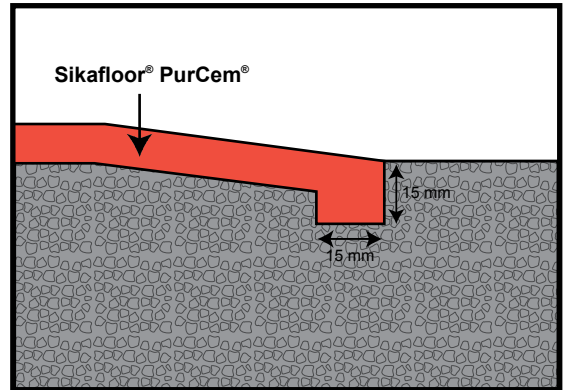

Sikafloor® PurCem® – Expansion joint

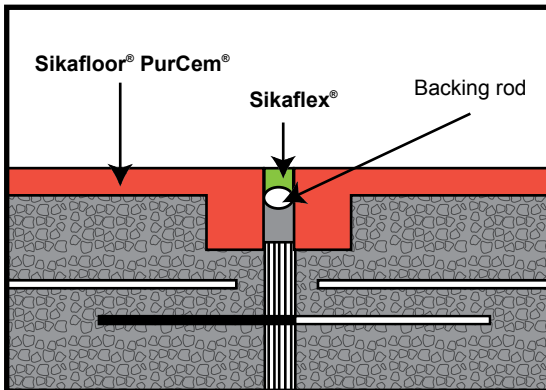

Sikafloor® PurCem® – Induced floor joint

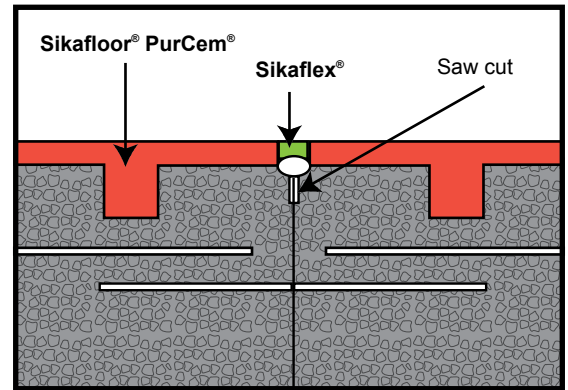

Sikafloor® PurCem® – Floor to wall cove

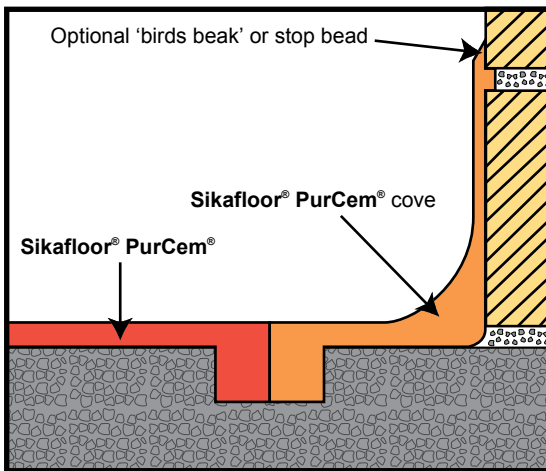

Sikafloor® PurCem® – Bumper / curp detail

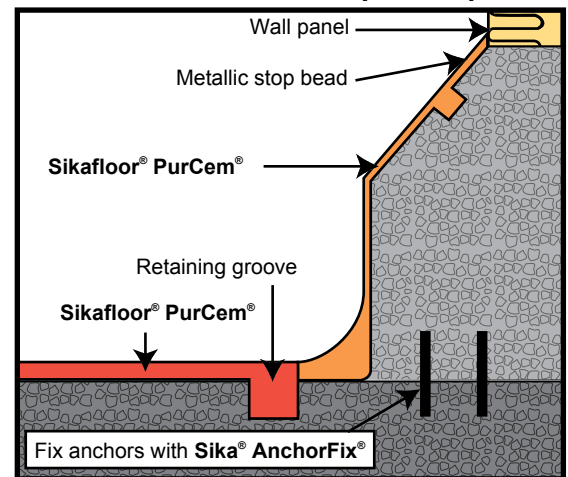

Sikafloor® PurCem®

Typical Installation Details

Sikafloor® PurCem® – Pre-formed trench

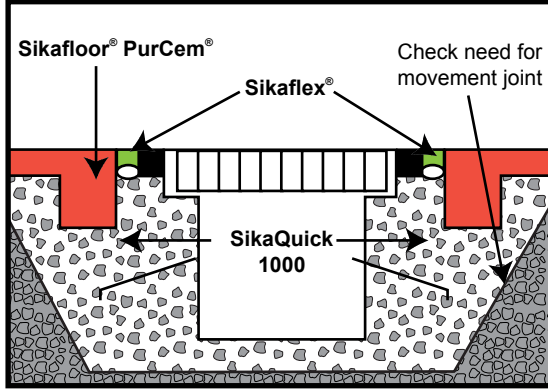

Sikafloor® PurCem® – Lined trench

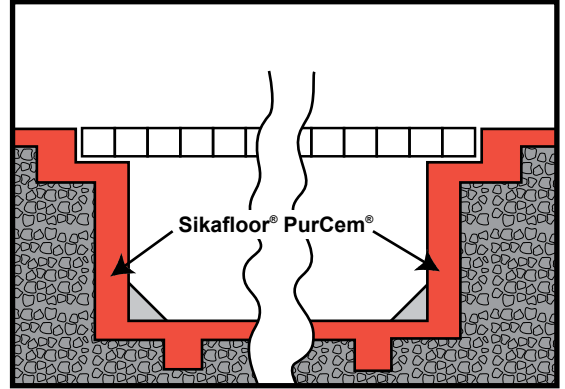

Sikafloor® PurCem® – Glazed drain edge detail

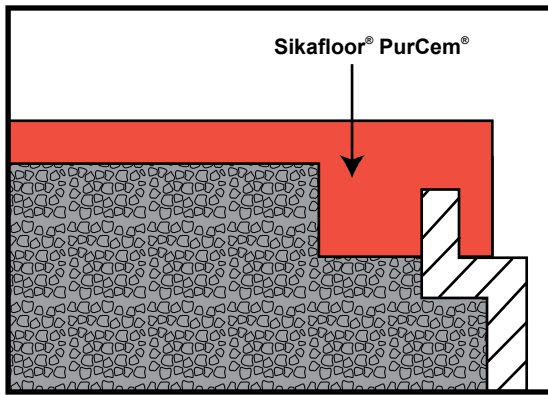

Sikafloor® PurCem® – Machine base

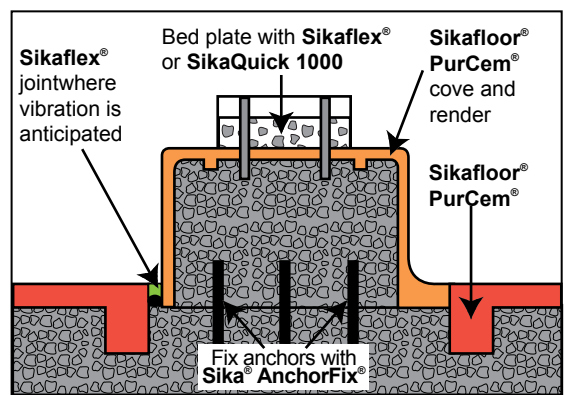

The information, and in particular, the recommendations relating to the application and end-use of Sika products, are given in good faith based on Sika's current knowledge and experience of the products when properly stored, handled and applied under normal conditions, within their shelf life. In practice, the differences in materials, substrates and actual site conditions are such that no warranty in respect of merchantability or of fitness for a particular purpose, nor any liability arising out of any legal relationship whatsoever, can be inferred either from this information, or from any recommendations, or from any other advice offered. The proprietary rights of third parties must be observed. All orders are accepted subject to our current terms of sale and delivery. Users should always refer to the most recent issue of the Technical Data Sheet for the product concerned, copies of which will be supplied on request or can be accessed in the Internet under www.sika.ca.

Sika Canada Inc.

601 Delmar Avenue
Pointe-Claire, QC H9R 4A9
Tel.: (514) 697-2610
Fax: (514) 697-3087

Ontario

6915 Davand Drive
Mississauga, ON L5T 1L5
Tel.: (905) 795-3177
Fax: (905) 795-3192

Alberta

18131-114th Avenue N.W.
Edmonton, AB T5S 1T8
Tel.: (780) 486-6111
Fax: (780) 483-1580

1-800-933-SIKA

www.sika.ca

An ISO 9001:2000 certified company
Pointe-Claire : ISO 14001:2004 certified EMS

