



FLOORING

Sikafloor® NA PurCem®

ADVANCED GENERATION POLYURETHANE-CEMENT SYSTEMS
FOR EXTREME SERVICE CONDITIONS: SELECTION GUIDE

**BUILDING TRUST
CONSTRUIRE LA CONFIANCE**



FLOORING SOLUTIONS FOR EXTREME SERVICE CONDITIONS

Sikafloor® NA Purcem® SERIES

The Sikafloor® NA Purcem® SERIES is an advanced generation of polyurethane-cement systems that have been specifically designed for extreme service conditions, such as those found in the food and beverage industry, manufacturing sectors and chemical storage or processing facilities.

Their properties make them ideal for use in areas subject to:

- Extremely demanding hygienic requirements, where frequent and intensive steam, hot water or chemically aggressive cleaning is required
- Wet or dry production processes
- Exposure to aggressive substances
- Stringent slip-resistance and safety requirements
- Extreme service temperatures from -40 to 90°C (-40 to 194°F), with certain systems accepting temperatures of up to 120°C (248°F)
- Heavy point loads and frequent and heavy traffic
- Impact and abrasion

The Sikafloor® NA Purcem® technology incorporates state-of-the-art formulations which provide improved user-friendly, resistant and durable solutions.



The Sikafloor® NA PurCem® systems offer the following performance-related advantages:

- Elimination of blistering associated with high temperature application and multi-layer applications
- Regulation compliance - approved for use by the food industry (CFIA, USDA)
- Chemical- and abrasion-resistance
- Thermal-shock resistance
- Tolerance of a wide range of service temperatures
- Very easy-to-clean
- Slip-resistance
- Multiple decorative styles available
Integral cove-base and detailing, providing seamless surfacing
- Pore-free, textured and non absorbent surfaces
- Minimal maintenance costs; superior life-cycle cost advantage vs. tile

The Sikafloor® NA PurCem® products are easy-to-apply, featuring:

- Water-dispersed and non-toxic applicator- and occupant-friendly products
- High tolerance to substrate moisture making it possible to apply onto 7 -10 day old concrete
- Longer pot life and even higher workability - increasing productivity, improving application and reducing waste
- Innovative and pre-measured packaging which reduces disposal demands and controls onsite mixing quality
- Primer-free application in most cases, allowing for single-step applications - further reducing installation time
- Quick-curing for fast-track use
- Available in a range of standard colours and special colours can be produced upon request

The Sikafloor® NA PurCem® range illustrates Sika's commitment to environmentally-conscious and durable products which promote a sustainable future. This series of systems offers a diverse selection of materials that comply with air quality mandates and help to contribute to Green building and LEED Canada initiatives through:

- Odour- and phthalate-free formulations
- Disposal- and landfill-friendly packaging
- Low-VOC emitting materials



HEAVY-DUTY, STEAM CLEANABLE TOPPINGS

Sikafloor®-19 NA PurCem®
POLYURETHANE-CEMENT FLOORING
TROWEL-APPLIED, SLIP-RESISTANT FINISH

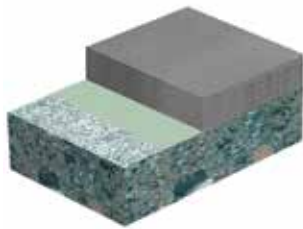

For heavy-duty applications designed to be applied at a thickness of 6 to 9 mm (1/4 to 3/8 in). Heat resistant to 120°C (248°F).

Ideal for the following environments:

- Beverage processing plants and distilleries
- Chemical processing plants and refineries
- Containment areas
- Dairies and milk-processing facilities
- Freezers and coolers
- Fryer areas
- Heavy-duty manufacturing facilities
- Institutional and commercial kitchens
- Meat, fish and poultry packing plants

Sikafloor®-20 NA PurCem®
POLYURETHANE-CEMENT FLOORING
SCREED-APPLIED, SLIP-RESISTANT FINISH

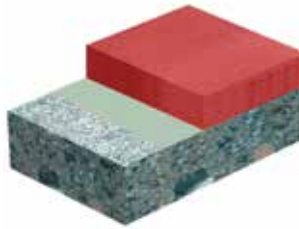

Easy to trowel screed for heavy-duty applications designed to be applied at a thickness of 6 to 9 mm (1/4 to 3/8 in). Heat resistant to 120°C (248°F).

Ideal for the following environments:

- Beverage processing plants and distilleries
- Chemical processing plants and refineries
- Containment areas
- Dairies and milk-processing facilities
- Food processing facilities
- Freezers and coolers
- Fryer areas
- Heavy-duty manufacturing facilities
- Institutional and commercial kitchens
- Meat, fish and poultry packing plants

Sikafloor®-15 NA PurCem® Accelerator is available to accelerate the cold temperature curing time and provide improve flow properties of Sikafloor®-19 NA PurCem® or Sikafloor®-20 NA PurCem®, for installations where the substrate temperature is between 7 and 18°C (45 and 64°F).



MEDIUM-DUTY, SELF-LEVELLING SCREEDS AND DETAILING MORTARS

Sikafloor®-22 NA PurCem®
POLYURETHANE-CEMENT FLOORING
SELF-LEVELLING, BROADCAST,
SLIP-RESISTANT FINISH

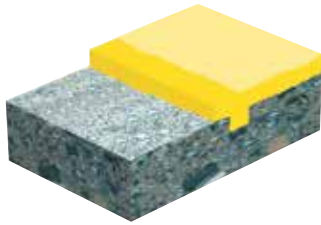

A medium-duty, self-levelling, broadcast with slip-resistant finish, designed to be applied at a thickness of 4.5 to 6 mm (3/16 to 1/4 in). Heat resistant to 120°C (248°F).

Ideal for the following environments:

- Animal housing and cage-washing areas
- Bottling lines
- Correctional facilities
- Food preparation areas
- Food processing areas
- Freezers and coolers
- Institutional and commercial kitchens
- Lockers and shower rooms
- Pharmaceutical manufacturing facilities
- Restaurant kitchens

Sikafloor®-24 NA PurCem®
POLYURETHANE-CEMENT FLOORING
SELF-LEVELLING, SMOOTH BUT
SLIP-RESISTANT TOPPING

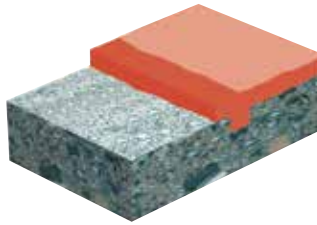

A medium-duty topping with a smooth but moderately slip-resistant finish, designed to be applied at a thickness of 2 to 4 mm (80 to 160 mils). Heat resistant to 120°C (248°F).

Ideal for the following environments:

- Warehouses
- Production facilities
- Laboratories and workshops, either with or without a Sikafloor® top coat

Sikafloor®-29 NA PurCem®
POLYURETHANE COVING AND
VERTICAL-GRADE DETAILING MORTAR

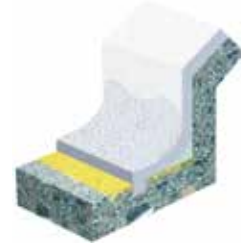

A high-strength trowel-applied coving and detailing mortar designed to be applied at a thickness of 3 to 6 mm (1/8 to 1/4 in). Heat resistant to 120°C (248°F).

Ideal for the following environments:

- Beverage processing plants and distilleries
- Chemical processing plants and laboratories
- Dairies and milk-processing facilities
- Food processing facilities
- Freezers and coolers
- Heavy-duty manufacturing facilities
- Institutional and commercial kitchens
- Warehouses and distribution centres

Sikafloor®-15 NA PurCem® Accelerator is available to accelerate the cold temperature curing time and provide improve flow properties of Sikafloor®-22 NA PurCem® or Sikafloor®-24NA PurCem®, for installations where the substrate temperature is between 7 and 18°C (45 and 64°F).

Sikafloor® Vertical Epoxy Primer is available for use as a tacky primer and adhesion promoter for the vertical application of Sikafloor®-29 NA PurCem®.



HIGH-BUILD COATINGS AND SYSTEM TOP COATS

Sikafloor®-31 NA PurCem®
HIGH-BUILD POLYURETHANE-CEMENT
PRIMER, COATING AND SYSTEM TOP COAT
ROLLER-APPLIED, HORIZONTAL AND
VERTICAL

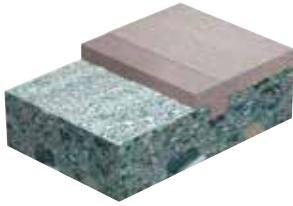

A matte finish coating, designed to be applied at a thickness of 10 mils per coat, as a primer/sealer for Sikafloor®-24 NA PurCem®, as a stand-alone coating* or as a system top coat for PurCem® broadcast-textured finishes. Not suitable for environments requiring steam cleaning. Service temperature of 90°C (194°F) when used as a stand-alone coating.

Ideal for the following environments:

- Chemical processing plants and laboratories
- Chemical storage areas
- Food preparation areas
- Food processing facilities
- Laboratories
- Warehouses
- Washrooms

Sikafloor®-33 NA PurCem®
UV-STABLE, HIGH-BUILD, POLYURETHANE
COATING ROLLER-APPLIED, HORIZONTAL AND
VERTICAL

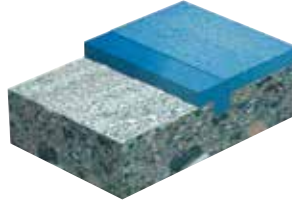

A matte finish coating, designed to be applied at a thickness of 10 mils per coat, as a stand-alone coating* or as a system top coat for PurCem® broadcast-textured finishes to minimize colour change due to UV-light exposure. Not suitable for environments requiring steam cleaning. Service temperature of 90°C (194°F) when used as a stand-alone coating.

Ideal for the following environments:

- Chemical processing plants and laboratories
- Chemical storage areas
- Food preparation areas
- Food processing facilities
- Laboratories
- Warehouses
- Washrooms

** As a stand-alone coating, material produces a smooth, matte surface. Must be applied as a broadcast body coat for slip resistance in wet environments. Use as a top coat applies to Sikafloor®-19 NA, -20 NA, -22 NA, -24 NA and -29 NA PurCem® systems only.*



TYPICAL FLOORING DETAILS

Properly-designed and correctly-installed edge, curb, cove, joint, trench, drain and machine base details, amongst others, are crucial to the creation of a successful and long-lasting floor finish. This particularly applies where severe service conditions need to be accommodated, such as elevated temperature or temperature gradients and steam/hot water cleaning.

Illustrated in this section, are a number of suggested installation details, all of which help to avoid localized failure and the potential for wide-scale deterioration of your working surface.

KEYED EDGE DETAIL

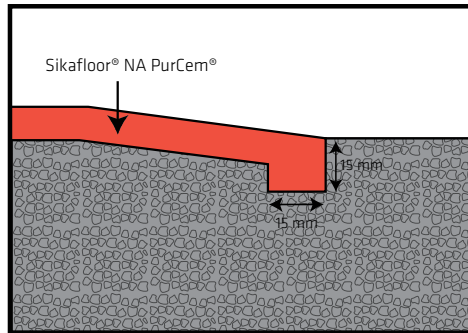

EXPANSION JOINT

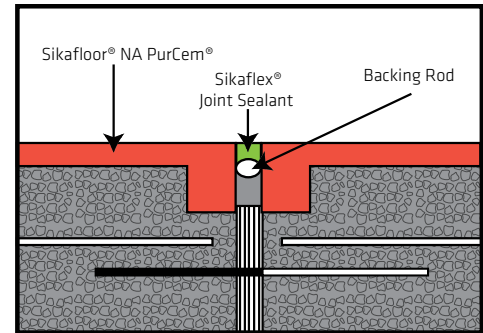

FLOOR TO WALL COVE

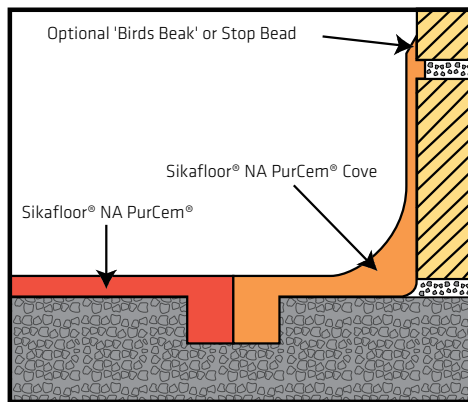

BUMPER / CURB DETAIL

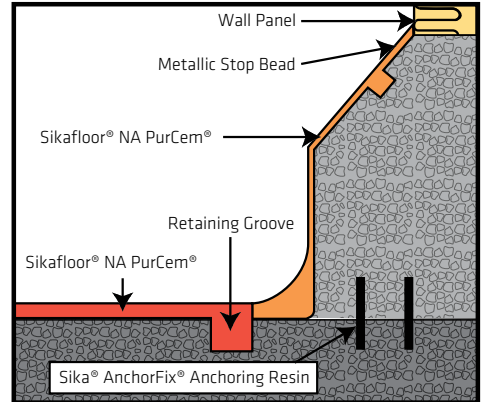

PRE-FORMED TRENCH

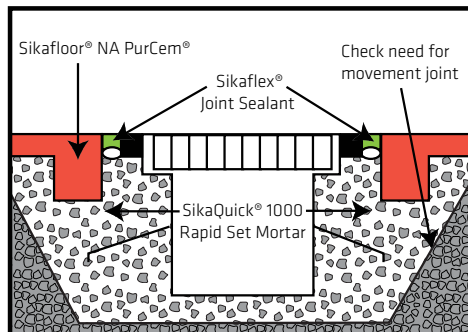

LINED TRENCH

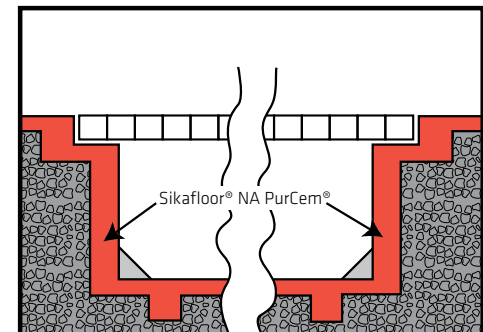

Please contact your local Sika Canada Flooring Technical Sales Representative for additional installation details and information, and for project-specific advice to ensure that a suitably-performing, durable and cost-effective floor is achieved.

SIKA SOLUTIONS FROM ROOF TO FOUNDATIONS

Roofing Systems



Sarnafil®
Sikaplan®
Sikalastic®

Concrete Production



Sika® ViscoCrete®
SikaRapid®
Sika® Air

Joint Sealing



Sikaflex®
Sikasil®
Sikadur® Combiflex

Grouting and Anchoring



SikaGrout®
Sikadur®
Sika AnchorFix®

Concrete Repair & Protection



Sika® MonoTop®
SikaTop®, SikaRepair®
Sikagard®

Structural Strengthening



Sikadur®, Sika® CarboDur®
SikaWrap®
Sika® CarboShear

Floor & Wall Systems



Sikafloor®
Sikagard®
Sikagard® Duroplast

Waterproofing Systems



SikaProof®, SikaFuko®
Sika® Greenstreak®
SikaSwell®, SikaFix®

Sika Canada Inc., a member of the Sika Group, is a leader in the field of speciality chemicals, for construction and manufacturing industries. Our product lines feature high quality roofing systems, concrete admixtures, mortars and resins, sealants and adhesives, structural strengthening components, industrial and decorative flooring, as well as protective coatings and waterproofing systems. Our expertise is borne out of a global presence and served by strong, local support. Sika has earned the trust of our industries for over 100 years, by delivering the highest standards of commitment and partnership.

Also Available:

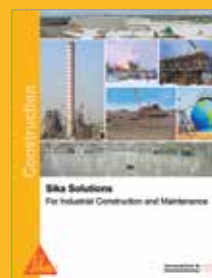
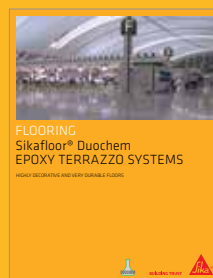
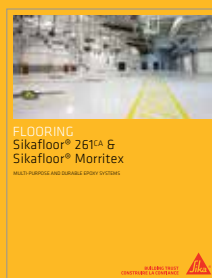

The information, and in particular, the recommendations relating to the application and end-use of Sika products, are given in good faith based on Sika's current knowledge and experience of the products when properly stored, handled and applied under normal conditions, within their shelf life. In practice, the differences in materials, substrates and actual site conditions are such that no warranty in respect of merchantability or of fitness for a particular purpose, nor any liability arising out of any legal relationship whatsoever, can be inferred either from this information, or from any recommendations, or from any other advice offered. The proprietary rights of third parties must be observed. All orders are accepted subject to our current terms of sale and delivery. Users should always refer to the most recent issue of the Product Data Sheet for the product concerned, copies of which will be supplied on request or can be accessed in the Internet under www.sika.ca.

SIKA CANADA INC.

Head Office
601, avenue Delmar
Pointe-Claire, Quebec
H9R 4A9

Other locations

Toronto
Edmonton
Vancouver

1-800-933-SIKA
www.sika.ca

An ISO 9001 certified company
Pointe-Claire: ISO 14001 certified EMS

BUILDING TRUST
CONSTRUIRE LA CONFIANCE

